



# MYK LATICRETE



## Leadership through Innovation

Adhesives • Grouts • Stone Care • Wall Putty • Waterproofing



**MIYK LATICRETE**







**MYK LATICRETE's** goal is to deliver innovative solutions and develop new and eco-friendly products to achieve leadership in the tile and stone installation industry.

We aim at excellence in customer satisfaction and service.



**Murali Yadama**  
Managing Director

MYK LATICRETE's belief in pulling out all the stops when it comes to innovation and a relentless hunger for quality, have seen it partner with global leaders in construction materials and technology.

A true blue success story in the Indian construction and building material industry, in a little over a decade, it has come to be acknowledged as a leader in the domain and credited with pioneering several products that are bringing about a sea change in age old practices and techniques.

A joint venture between the world leader LATICRETE International Inc., USA - a pioneer in building material and construction technology, and the Hyderabad based MYK Group of Companies - a diverse conglomerate with interests in cement, machinery manufacturing, textiles, construction chemicals and industrial fans, MYK LATICRETE is bringing contemporary world standards to the tile and stone installation and maintenance industry in India.



MYK LATICRETE R&D Center - Hyderabad

Since inception in 2001, remarkable strides have been taken and impressive growth recorded. Today, our operations span 19 regional offices, a 2000-strong nationwide dealer / distributor network and 4 state-of-the-art manufacturing facilities in Sotanala, Perundurai, Kalol and Hyderabad.

The commissioning of the automated facility at Hyderabad is another feather in our cap.



MYK LATICRETE Factory, Sotanala



MYK LATICRETE Factory, Perundurai

A first of its kind in India, the unit, designed & engineered by a globally renowned Italian firm, is completely automated to enable greater consistency in product quality due to minimal human intervention.

At MYK LATICRETE, predicting and anticipating future trends has always been our forte. Enabling us to stay ahead of the curve is an advanced research and development center which is equipped to develop innovative products, evaluate tile and stone installation materials as per ANSI, EN, BS and BIS standards, and provide technical solutions for customer needs.

Committed to enhancing customer value through customer education, an exclusive Training Center has also been set up at Hyderabad, where architects, engineers, interior designers, students and dealers learn and get first-hand experience of the usage and application of new products developed by MYK LATICRETE.

We have and will always continue to share a common goal with all our customers and trade partners - to continually strive for the highest quality of construction through ground-breaking innovation.

An exciting product portfolio:

MYK LATICRETE's world class product range includes adhesives, grouts, stone care, waterproofing, wall putty and plaster, which have set new benchmarks in the industry. The impeccable quality and unmatched efficiency of the installation systems have made them the first choice of smart builders, architects and interior designers.



**SCREED .....11**



**WATERPROOFING ..... 13**

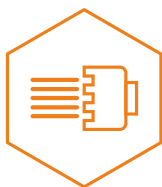

**TILE ADHESIVES ..... 15**



**GROUTS ..... 25**



**STONE CARE PRODUCTS ..... 29**



**CEMENT ADDITIVES ..... 36**



**LATAFINISH WALL PUTTY ..... 37**



Architectural Drawings	4
<b>Specialists in System based Installation Solution</b>	<b>5</b>
Facade	6
Pools & Waterbodies	7
Commercial Flooring	8
Residential Tiling	9
Industrial Flooring	10
<b>SCREED</b>	<b>11</b>
LATICRETE® 226 Thick-Bed Mortar	12
LATICRETE® 3642 Latex Concentrate for Thick-Bed Mortar	12
LATASCREED® 100	12
<b>WATERPROOFING</b>	<b>13</b>
LATICRETE® Hydro Ban®	14
LATICRETE® 9237 Waterproofing Membrane	14
<b>TILE ADHESIVES</b>	<b>15</b>
<b>Latex Fortified Adhesives</b>	
LATICRETE® 111 Crete Filler Powder	16
LATICRETE® 73 Latex Crete Admix	16
LATICRETE® 4237 High Performance Latex Admix	17
<b>Polymer Modified Adhesives</b>	
LATICRETE® 254 Platinum Adhesive	17
Xtra Bond FSA 336 Adhesive	18
LATICRETE® 335 Maxi Multipurpose LFT Adhesive	18
LATICRETE® 335 Super Flex Multipurpose Floor & Wall Tile Adhesive	19
LATICRETE® 325 High Flex Ag Silver Floor & Wall Tile Adhesive	19
<b>Polymer Based Adhesives</b>	
LATICRETE® 315 Plus Premium Floor and Wall Tile Adhesive	20
LATICRETE® 307 Floor and Wall Tile Adhesive	20
LATAFIX 305 Floor and Wall Tile Adhesive	21
<b>Epoxy Adhesive</b>	
LATAPOXY® 300 Epoxy Adhesive	21
<b>Spot Bonding Adhesive</b>	
LATAPOXY® 310 Epoxy Chemical Anchor	22
<b>Speciality Adhesives</b>	
MYK LATICRETE PUA 212™	22
AAC Block Adhesive	23
MYK LATICRETE DWA 215™	23
<b>Stone Adhesives</b>	
LATICRETE® 320 Thick Bed Adhesive	24
LATICRETE® 340 Medium Bed Adhesive	24

<b>GROUTS</b>	<b>25</b>
<b>Stainfree Grout</b>	
MYK LATICRETE STELLAR™ Grout	26
SP-100™ Stainfree Grout for Floor N' Wall	26
<b>Cementitious Grout</b>	
LATICRETE® 600 Series Unsanded Grout	27
LATICRETE® 500 Series Sanded Grout	27
<b>Grout Admix</b>	
LATICRETE® 1776 Grout Admix Plus	27
<b>Speciality Grout</b>	
LATAPOXY® Dazzle™ Grout for Floor N' Wall	28
LATAPOXY® 2000 Industrial Epoxy Grout	28
<b>STONE CARE PRODUCTS</b>	<b>29</b>
<b>Sealers</b>	
MaxiSeal plus	30
MaxiSeal aqua	30
MaxiSeal	31
LATICRETE® 190 Sealer	31
<b>Colour &amp; Gloss Enhancers</b>	
Preserva plus	32
Preserva	32
<b>Cleaners</b>	
ClenzaEG	33
ClenzaGA	33
ClenzaEF	34
ClenzaMC	34
<b>Tile Cleaner</b>	35
Clenza TC	35
<b>CEMENT ADDITIVES</b>	<b>36</b>
Super Set®	36
Super Set® IWP	36
<b>LATAFINISH® WALL PUTTY</b>	<b>37</b>
LATAFINISH® Wall Putty - Fine Finish	38
LATAFINISH® Wall Putty - Coarse Finish	38
<b>Product Recommendation Chart</b>	39
<b>Product Recommendation Chart</b>	40

# ARCHITECTURAL DRAWINGS

## Thin-Bed Floor Installation Details

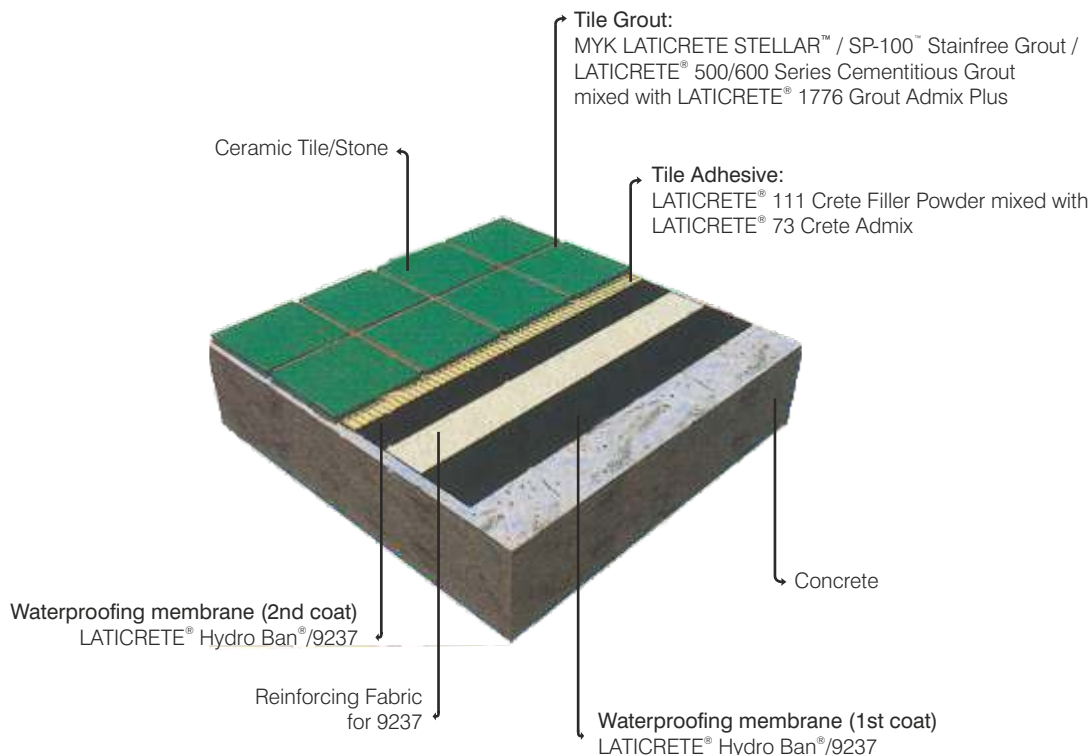

## Thick-Bed Floor Installation Details

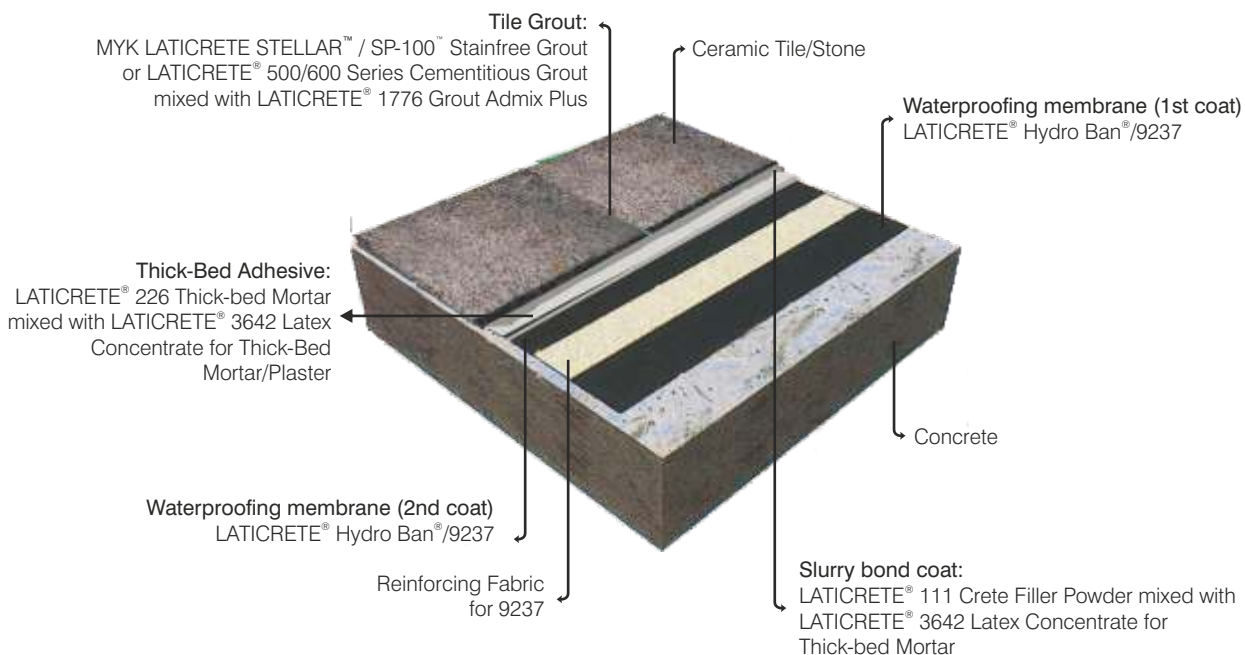

Note: LATICRETE® Hydro Ban® does not require use of Reinforcing Fabric

## Specialists in System-based Installation Solutions

At MYK LATICRETE, we believe we are not selling just products but offering you world class solutions to enable better design and faster execution.

Our installation systems are specially innovated for those who love to experiment with new materials and techniques that lend their creativity a unique touch and a standout quality. We will partner you in the quest to push back the boundaries and set fresh benchmarks.

On the following pages, we showcase some of our popular installation systems.



Facade



Pools & Water Bodies



Commercial Flooring



Residential Flooring



Industrial Flooring





## FACADE SYSTEM

MYK LATICRETE Exterior Facade System is the benchmark of the industry. The installation system comprises of Plaster, Adhesive and Grout to provide a permanent solution, ensuring maximum installation speed and strength for tile, brick and stone facades

### Advantages

- High strength
- Impervious to freeze-thaw
- Immune to climate change
- Earthquake shock resistant

### Product Recommendations

Area of Installation	Product recommended
Adhesive	LATICRETE® 111 Crete Filler Powder + LATICRETE® 73 Latex Admix / L 335 Super Flex
Grout	LATICRETE® 600 or 500 Series / MYK LATICRETE STELLAR™

## ARCHITECTURAL DRAWING FOR FACADE SYSTEM



### EXTERNAL WALLS / FACADES with Vitrified/Ceramic/Natural Stones

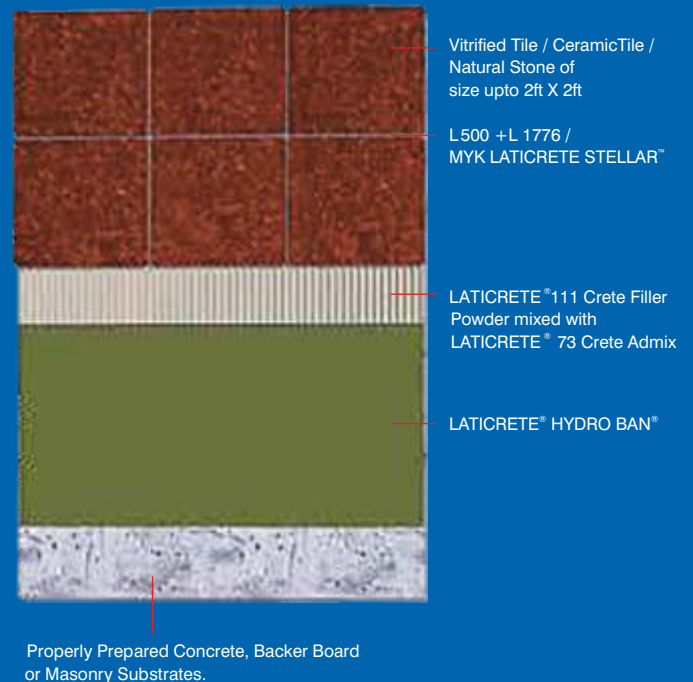



# POOLS, SPA & WATER BODIES SYSTEM

MYK LATICRETE offers the perfect solution for the installation of tiles in pools & water bodies. The system includes Screed, Waterproofing, Tile Adhesive and Grout that are up to the challenge of continuous submerged and wet area applications. Designed to resist chemicals, shock treatment and pH imbalance of water, the MYK LATICRETE system provides flexibility and high strength for these demanding, high performance applications.

## Advantages

- High strength & shock resistant
- Resistant to chemicals & pH imbalance of water
- Faster installation

## Product Recommendations

Area of Installation	Product recommended
Screed	L 226 + L 3642 / LATASCREED® 100 + Sand
Waterproofing	Hydro Ban® / L 9237
Adhesive	L 254 Platinum / L 111 + L 73 / L 335 Super Flex
Grout	SP-100™ / MYK LATICRETE STELLAR™

## ARCHITECTURAL DRAWING FOR SWIMMING POOL SYSTEM

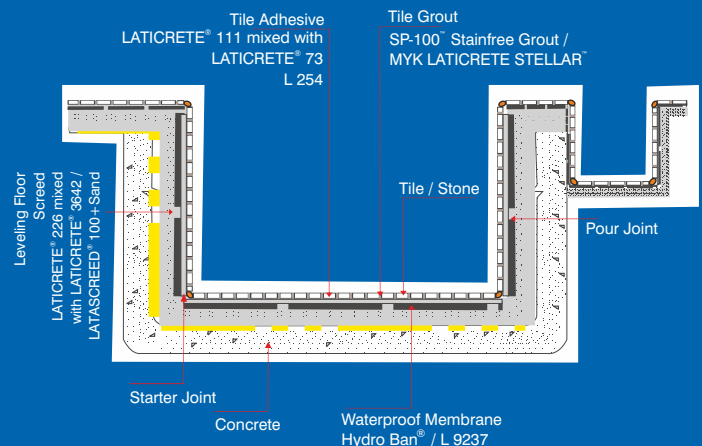



# COMMERCIAL FLOORING SYSTEM

For flooring that is subject to heavy traffic, MYK LATICRETE's Commercial Floor Installation System ensures that the challenge is easily met. The system comprises of Screed, Adhesive and Grout.

## Advantages

- Easy to install
- Saves time and money
- Low maintenance, high durability floors

## Product Recommendations

Area of Installation	Product recommended
Screed	LATASCREED® 100
Adhesive	LATICRETE® 325 High Flex
Grout	SP-100™ / MYK LATICRETE STELLAR™

## ARCHITECTURAL DRAWING FOR COMMERCIAL FLOORING SYSTEM

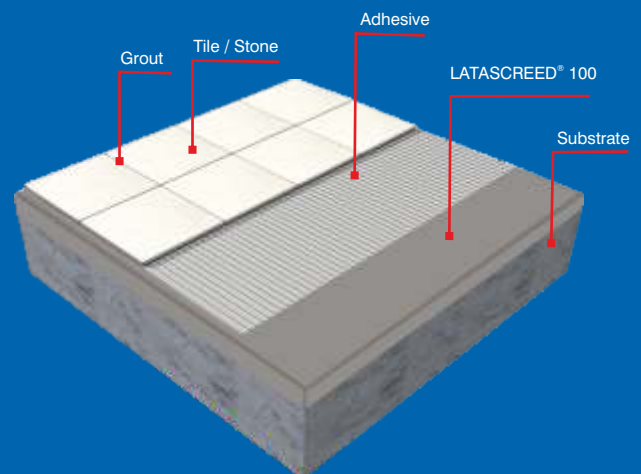





# RESIDENTIAL TILING SYSTEM

For your dream home, MYK LATICRETE offers a range of world class products, which includes screed, waterproofing, adhesives, grouts & cleaners that makes a world of difference - to the quality of construction as well as the aesthetics.

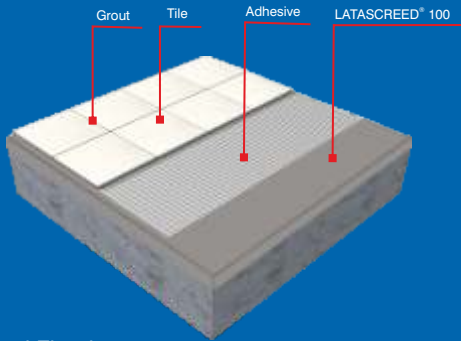

## General Flooring

### Product Recommendations

Area of Installation	Product recommended
Screed	LATASCREED® 100
Adhesive	L 325 High Flex / L 315 Plus
Grout	SP-100™ / MYK LATICRETE STELLAR™

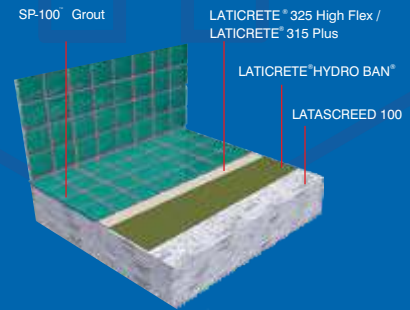

## Bathrooms

### Product Recommendations

Area of Installation	Product recommended
Screed	LATASCREED® 100
Waterproofing	Hydro Ban®
Adhesive	L 315 Plus (for Ceramic Tile) L 325 High Flex (for Vitrified Tile)
Grout	SP-100™ / MYK LATICRETE STELLAR™
Cleaners	Clenza TC

# ARCHITECTURAL DRAWINGS FOR DRYWALL TILING SYSTEM

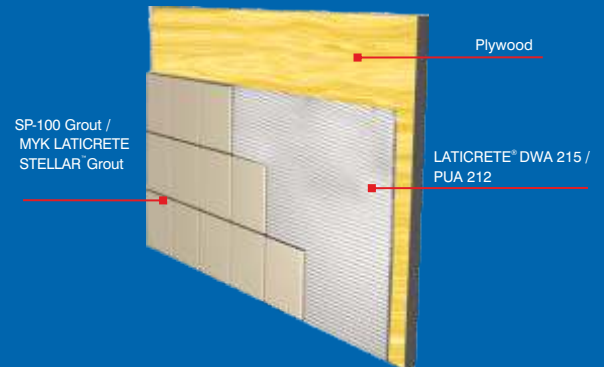

Area of Installation	Product recommended
Adhesive	MYK LATICRETE DWA 215™ / MYK LATICRETE PUA 212™ (for metal tiles on plywood)
Grout	SP-100™ / MYK LATICRETE STELLAR™



# INDUSTRIAL FLOORING SYSTEM

The MYK LATICRETE Industrial Flooring System offers low maintenance, high performance installation for all types of tile and stone in demanding industrial conditions. The system comprises of screed, latex fortified adhesive, specialty adhesive and chemical resistant industrial epoxy grout.

## Advantages

- High strength, impact & thermal shock resistant
- Chemical resistant, hygienic and steam cleanable
- Excellent for short "downtime" installations
- Superior load & heavy traffic performance

## Product Recommendations

Area of Installation	Product recommended
Screed	L 226 + L 3642
Waterproofing(optional)	Hydro Ban®
Adhesive	L111 + L 73 or L 4237/L 300 for high chemical resistance MYK LATICRETE PUA 212™
Grout	L 2000

## ARCHITECTURAL DRAWING FOR INDUSTRIAL FLOORING SYSTEM



LATAPOXY® 2000  
Industrial Epoxy Grout (walls)

LATICRETE® 111 Crete Filler Powder mixed with LATICRETE® 73 Crete Admix or LATICRETE® 4237 Latex Admix / LATAPOXY® 300 Adhesive / MYK LATICRETE PUA 212™

LATICRETE® HYDRO BAN®

LATICRETE® 226 Crete Filler Powder mixed with LATICRETE® 3642 Crete Admix / LATASCREED® 100

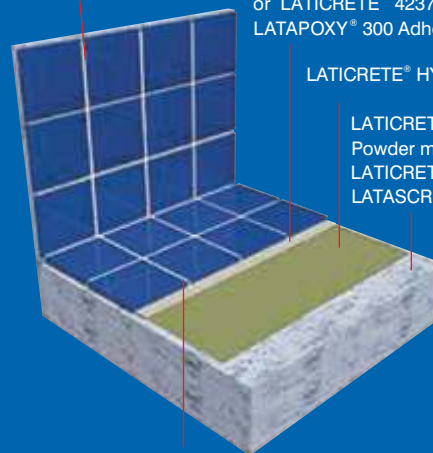

LATAPOXY® 2000  
Industrial Epoxy Grout



# SCREED

Just imagine. A screed that doesn't require curing!

This breakthrough innovation is the result of MYK LATICRETE's determined R&D efforts to come up with a solution for the shortcomings of traditional screed.

MYK LATICRETE's new age, polymer enhanced screed is engineered cement which, besides ensuring a level, strong base for perfect tile and stone installation, also offers a host of other benefits.

## Advantages

- High quality underlayment for long-lasting tile installation.
- Self curing - saves time, costs and enables faster construction
- No shrinking and cracking
- High strength and workability
- External and internal applications
- Resistance to environment and temperature variations
- Highly durable





## SCREED

**226**
**+**
**3642**
**Thick Bed Mortar**
**Latex Admix**

### LATICRETE® 226 THICK BED MORTAR

A factory prepared blend of raw materials, portland cement and graded aggregates, it is designed for use with LATICRETE® 3642 Latex Admix and water to produce high strength thick bed adhesive upto 50 mm for installation of all types of ceramic tiles, vitrified tiles & natural stone. The mixture can be used as interior & exterior cement plaster or as screed for floors & walls.

**Applications:** Interior & exterior floors & walls

**Advantages:** • Premixed factory blended • Can be applied from 12 mm to 50 mm in one application • Two component - to be mixed with L3642 latex concentrate • High strength, flexible, shock and impact resistant

**Suitable Substrates:** Concrete & Cement Mortar Bed      **Coverage:** Varies by application

**Packaging:** 50 kg bag      **Colour:** Grey & White

### LATICRETE® 3642 LATEX CONCENTRATE FOR THICK BED MORTAR

LATICRETE® 3642 is a concentrated Latex Admix which is diluted with water on site and then mixed with LATICRETE® 226 Thick Bed Mortar to make cement plasters, renders, coatings, mortar beds and screed. It has greatly improved physical characteristics and can be used in exterior, interior as well as underwater plasters, screeds and renders.

**Advantages:** • Increased bond and compressive strength • Water resistant; suitable for submerged applications • Superior flexibility • Can be used for repairs and patching of concrete

**Coverage:** Varies by application

**Packaging:** 5 ltr. & 20 ltr. pails

**Note:** L3642 can also be used as primer for dry wall board tiling and screeding.

**Compliance:** Meet the following standards

• EN 13813, as CT-C20 F6 B2 SH60      • VOC: Very low

**100**

### LATASCREED® 100

A factory prepared blend of carefully selected speciality raw materials, portland cement and graded fillers, it is designed for use with water and aggregates to produce high strength, water retaining and self curing screed for interior and exterior floor applications. It meets and exceeds the requirements of National and International Standards.

**Advantages:**

• High strength • Shock and impact resistant • Water retaining and self curing • No shrinkage

**Suitable Substrates:**

• Concrete • Cement Mortar Beds (compressive strength > 25 Mpa) • Cement Terrazzo

**Coverage:** Coverage will be based on following mix design. the grain size matrix has to be uniformly distributed up to a size of 8 mm. (Minimum thickness: 12 mm; Maximum thickness: 70 mm)

**Packaging:** 25 kg bag

**Colour:** Grey

**Compliance:** Meet the following standards

• EN 13813, as CT-C30 F5 B1 5SH50 • VOC: Practically Nil



# WATERPROOFING

What happens when the substrate you have waterproofed develops a crack? Water seepage, right? Wrong!

MYK LATICRETE has innovated in this critical area to bring you a game-changing product. The advanced single component waterproofing membrane has the unique ability to bridge cracks in the substrate (up to 3 mm), and requires no other additional accessories for exceptional performance. The under-tile waterproofing membranes are especially recommended for tiled wet areas, washrooms, kitchens, swimming pools and other water bodies.

## Advantages

- Unique feature - substrate crack bridging (up to 3mm).
- Highly flexible - to adjust to structural movement.
- Extremely versatile - suitable for various substrates such as concrete, steel, copper etc.
- Easy to apply.
- Load bearing - tiles can be fixed directly on the membrane.



## WATERPROOFING



### Hydro Ban®

#### LATICRETE® Hydro Ban®

LATICRETE® Hydro Ban® is a thin, load bearing waterproofing/ crack isolation membrane that does not require the use of fabric in the field, coves or corners. It is a single component self curing liquid rubber polymer that forms a flexible, seamless waterproofing membrane. LATICRETE® Hydro Ban® bonds directly to a wide variety of substrates.

#### Applications:

• Interior and exterior • Swimming pools, fountains and water bodies • Shower pans, stalls and tub surrounds • Industrial, commercial and residential bathrooms and laundries • Spas and hot tubs • Kitchens and food processing areas • Terraces and balconies over unoccupied spaces • Countertops and facades • Steam rooms (when used in conjunction with vapour barrier)

#### Advantages:

• Single component • No fabric required for joints upto 3mm • Bonds directly to copper, steel & PVC plumbing fixtures • Fast drying, allows for flood test in 72 hours

#### Suitable Substrates:

• Concrete & brick masonry • Cement mortar beds • Cement plaster • Gypsum wallboard\* • Exterior glue plywood\* • Ceramic tile & stone\*\* • Cement terrazzo\*\* • Cement backer board\*\*\*

\*Interior applications only.

\*\*If skim coated with LATICRETE® Latex Thin-set Mortar

\*\*\*Consult cement backer board manufacturer for specific installation recommendations and to verify acceptability for exterior use.

**Coverage:** Approx. 225-250 sq. ft. per 20 ltr pail    **Packaging:** 20 ltr pail

**Compliance:** Meet the following standards

• ANSI: A118.12 • ANSI: A118.10, ETAG: 022    • VOC: Very low



### 9237

#### LATICRETE® 9237 Waterproofing Membrane

It is a roller applied, liquid waterproofing membrane for direct use under thin and thick-bed installations of ceramic tile, stone and other finishes. It is recommended for residential and commercial floor and wall installations.

#### Applications:

Kitchens, bathrooms, swimming pools, terrace gardens etc.

#### Advantages:

• Fast and easy to install – applied like paint • Water cleanable when fresh • Non-flammable • Proven history

#### Suitable substrates:

• Concrete & brick masonry • Cement mortar beds • Cement plaster • Gypsum wallboard • Exterior grade plywood • Ceramic tile & stone • Cement terrazzo • Cement backer board

**Coverage:** Approx. 200-225 sq. ft. per 20 ltr pail

**Packaging:** 5 ltr & 20 ltr pails

**Compliance:** Meet the following standards

• EN 14891 • ANSI: A118.10 • VOC: Very low

**Note:** Membrane reinforcing fabric for coves, corners and broad joints is sold separately.

**Fabric roll packing:** width - 15 cm and length - 18 m to 25 m





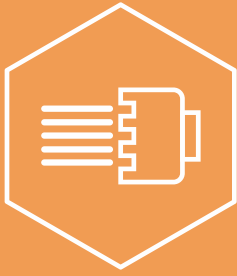

# TILE ADHESIVES

Across the world, the winds of change are sweeping away traditional methods of installing tiles and stones as these have proven to be incapable of handling modern products and materials.

Rising to meet the challenge is MYK LATICRETE's range of new age polymer tile adhesives. Far superior to conventional methods, these tile adhesives break the shackles imposed on your creativity by allowing you to experiment with aesthetics. For instance, you can now even think of fixing a marble slab on the ceiling! Finally, today's construction needs have met their match in MYK LATICRETE adhesives.

## Advantages

- Easy to apply
- Higher working time
- Suitable for any substrate
- Wide range for diverse applications
- Enable faster completion of job - savings of time and money
- Expand the scope for aesthetics and quality of interiors
- No curing required



## Latex Fortified Adhesives

**111**
**+**
**73**

Crete Filler Powder

Latex Admix

### LATICRETE® 111 CRETE FILLER POWDER

LATICRETE® 111 Crete Filler Powder is a factory prepared blend of carefully selected raw materials, portland cement and graded aggregates. It is designed for use with LATICRETE® 73 Crete Admix to produce high strength adhesive for fixing all varieties of small to large format tiles and stones. For very large format & thin tiles/stones LATICRETE® 4237 Latex admix should be used in place of LATICRETE® 73

**Applications:** Designed specially for interior & exterior floor & wall installations of all types of tiles & stones.

#### Advantages:

- Exceeds ANSI A 118.4 ET & EN 12004/ISO 13007: C2TE S1 • High strength formula & ultimate flexibility • Ideal for external facades and underwater applications

#### Suitable Substrates:

- Concrete • Cement Mortar Beds • Ceramic Tiles and Stones • Cement Backer Board • Concrete Masonry • Cement Plaster • Brick Masonry • Cement Terrazzo • Gypsum Wallboard (interior only)

**Coverage:** Approx. 55-60 sq.ft. per 20 kg bag using a ¼" x ¼" (6mmx6mm) notch trowel for a bed of 3mm.

**Bed Thickness:** Can be used upto 12 mm

**Packaging:** 20 kg bag    **Colour:** Grey & White

**Compliance:** Meet the following standards

- ANSI A 118.4 ET    • EN 12004 / ISO 13007: C2TE S1 • IS 15477: 2019 : TYPE 3 TS1 ADHESIVE • VOC: Practically Nil



### LATICRETE® 73 LATEX CRETE ADMIX

LATICRETE® 73 is a Latex Crete Admix mixed with LATICRETE® 111 Crete Filler Powder / Adhesives to form tile setting beds. Tile setting adhesives made with LATICRETE® 73 Crete Admix provide increased flexibility, stronger bond and compression strength when compared to conventional portland cement mortars. This increased bond strength is especially vital when installing semi and fully vitrified tiles, quarry tiles, pavers and other ceramic floor and wall tiles used in highly critical areas such as external facades, industrial plants, swimming pools and heavy traffic areas. Also provides longer potlife & working time in hot weather conditions.

#### Advantages:

- High flexibility • High shock and impact resistance • High compressive strength – Exceeds ANSI A 118.4 ET requirement • Ideal for bonding large format tiles and vitrified tiles.

**Coverage:** Approx. 55-60 sq.ft. per 5 ltrs., mixed with 20 kg bag of LATICRETE® 111 Crete Filler Powder / Adhesive using a ¼" x ¼" (6mm x 6mm) square notch trowel for a bed of 3mm.

**Packaging:** 5 ltr. & 20 ltr pails

**Note:** Can be mixed with L 305 / L307 / L 315 Plus to enable better flexibility for external use.

### LATICRETE® 73 RAPID CRETE ADMIX

LATICRETE® 73 Rapid is a specially designed Latex Crete Admix for use with LATICRETE® 111 Crete Filler Powder to make high strength, rapid setting latex fortified thin-set adhesives. Suitable for installation of all types of ceramic and vitrified tiles, industrial tiles, natural stones and agglomerates.

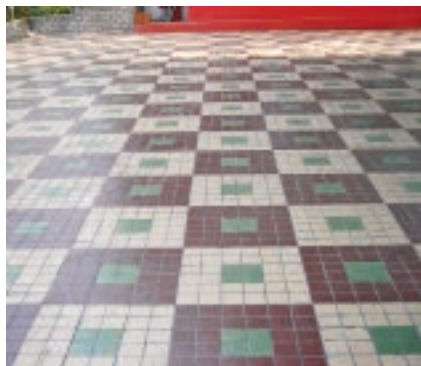

## Latex Fortified Adhesives

**111**
**+**
**4237**

Crete Filler Powder

Latex Admix



### LATICRETE® 4237 HIGH PERFORMANCE LATEX ADMIX

LATICRETE® 4237 Latex Admix is a specially designed high performance Latex additive for use with LATICRETE® 111 Crete Filler Powder to make high strength thin bed adhesive. It is suitable for installation of all types of ceramic tiles, vitrified tiles, natural stones & agglomerates. It has superior bond strength & flexibility and is also highly resistant to shock & impact.

These features make it a premium choice for installation of tile & stone in highly demanding areas such as external facades, industrial floors, high traffic areas etc.

#### Applications:

Designed for installation of all types of ceramic tiles, vitrified tiles, brick, natural stones and agglomerates, LATICRETE® 4237 Latex admix offers the speed and economy of adhesives with the permanent, water resistant dependability of portland cement.

#### Advantages:

- Superior bond strength • Flexible and shock & impact resistant • Rated for extra heavy traffic conditions • Proven versatility

**Coverage:** Approx. 55-60 sq. ft per 5 ltrs, mixed with 20 kg bag LATICRETE® 111 Crete Filler Powder / Adhesive using a ¼" x ¼" (6mm x 6mm) square notch trowel for a bed of 3 mm.

**Bed Thickness:** Can be used upto 12 mm

**Packaging:** 20 ltr. pail

**Compliance:** Meet the following standards

- ANSI: A118.4 ET • EN 12004/ISO 13007 : C2TE S1 • IS 15477: 2019 : TYPE 3 TS1 ADHESIVE • VOC: Very low

## Polymer Modified Adhesives

**254**

### LATICRETE® 254 PLATINUM ADHESIVE

The ultimate one-step, polymer fortified flexible mortar for external facade installation of ceramic tiles, vitrified tiles, stones, quarry tiles, pavers and brick. Superior strength, flexibility to handle structural movements, non-sag property and taking on extreme weather conditions, are among its features. Mixed with water, it has a long open time with unsurpassed adhesion and workability. It is an approved substitute for LATICRETE® 111 powder mixed with LATICRETE® 73 Latex Additive.

**Applications:** Excellent for facades & underwater applications, both interior & exterior areas.

**Advantages:** • Ultimate bond strength. Can be used on various dry walls directly • Exceeds ANSI A 118.4 ET/11(EGP) & EN 12004 for C2TES1 • Excellent for underwater applications • Single component, just add water

**Suitable Substrates:** • Concrete • Concrete Masonry • Cement Mortar Beds • Cement Plaster • Ceramic Tile and Stone • Brick Masonry • Cement Backer Board\*\* • Cement Terrazzo • Exterior Grade Plywood\* • Gypsum Wallboard\* • Calcium Silicate board \*

\*Interior use only \*\*Consult the backer board manufacturer's data sheet for the specific recommendations.

**Coverage:** Approx. 55-60 sq.ft. per 20 kg bag using a ¼" x ¼" (6mm x 6mm) notch trowel for a bed of 3mm.

**Bed Thickness:** Can be used upto 12 mm

**Packaging:** 20 kg bag

**Colour:** Grey and White

**Compliance:** Meets the following standards • ANSI: A118.4 ET/11(EGP) • EN 12004 / ISO 13007 : C2TE S1 • IS 15477: 2019 : TYPE 3 TS1 ADHESIVE • VOC: Practically Nil





## Polymer Modified Adhesives

**336**

### XTRABOND FSA 336 ADHESIVE

A multipurpose polymer modified rapid drying (fast setting) adhesive, suitable for new installations with low down time and quick repairs. Designed especially for moisture sensitive natural stone applications on floor and wall.

#### Applications:

Designed specially for interiors, exterior floor & wall installations of all types of ceramic tiles, vitreous tiles, semi-vitreous tiles, glass mosaic tiles, precast terrazzo and natural stones over concrete and a variety of substrates.

#### Advantages:

- High strength, polymer modified • Fast setting (Rapid drying) • Good working time
- Easy to use & part of MBS (Moisture barrier system) • Exceeds ANSI A 118.4 FT

**Coverage:** Approx. 55-60 sq.ft. per 20 kg bag with a 1/4" x 1/4" (6mm x 6mm) square notch trowel for a bed of 3 mm

**Bed Thickness:** Can be used upto 12 mm

**Packaging:** 20 kg & 50 kg bags

**Colour:** Grey & White

**Compliance:** Meets the following standards

- ANSI A 118.4 FT • EN 12004 / ISO 13007: C2 FT • IS 15477: 2019 : TYPE 2 T ADHESIVE
- VOC: Practically Nil

**335  
MAXI**

### LATICRETE®335 MAXI MULTIPURPOSE LFT ADHESIVE

A highly polymer modified and highly flexible adhesive for installation of large format/ slim tiles on most of the substrates to accommodate movements. It offers very good handling properties with good sag and slump resistance while doing installation on wall or floor respectively. It can be applied up to 18 mm bed thickness.

#### Applications:

Designed especially for interior and exterior floor and wall installations of all types of ceramic tile, vitreous, semi-vitreous tile, paper faced glass mosaic tiles, precast terrazzo and natural stones over concrete and on a variety of substrates. Good underwater shear bond allows this product to be used for wet areas like swimming pools, sauna, water bodies and washrooms. Can be used for tile on tile applications and as slurry bond adhesive in wet on wet applications.

#### Advantages:

- For fixing extra large format tiles & thin body tiles on demanding internal & external applications • Highly Flexible, Light weight formula. More than 15% higher coverage than standard adhesive • Cream & non sag formula for easier installation on floor and wall
- Non-slump adhesive with a bed thickness up to 18 mm

#### Suitable Substrates:

- Slim porcelain large format tiles • Vitreous, semi vitreous or non- vitreous tiles; ceramic; quarry, cement body tile • Brick • Cement based precast terrazzo • Natural stone tile

#### Coverage:

Approx 72 - 78 sft per 25 kg bag with (6mmx6mm) square notch trowel for a bed of 3 mm

**Bed Thickness:** Can be used upto 18 mm

**Packaging:** 25 kg bags

**Colour:** Grey

**Compliance:** Meets the following standards

- ANSI A118.4 ET • EN 12004 / ISO 13007 : C2TE S1 • IS 15477: 2019: TYPE 3 TS1 ADHESIVE • VOC: Practically Nil





## Polymer Modified Adhesives



### 335 SUPER FLEX

#### LATICRETE® 335 SUPER FLEX MULTIPURPOSE FLOOR AND WALL TILE ADHESIVE

A multipurpose high polymer modified adhesive for interior and exterior installation of ceramic tiles, stone, quarry tiles, glass mosaic tiles, pavers and bricks. LATICRETE® 335 Super Flex Multipurpose Floor and Wall Tile Adhesive is designed to mix with water and has a convenient open time with high adhesion & workability. LATICRETE® 335 Super Flex Multipurpose Floor and Wall Tile Adhesive is compliant with EN and ANSI standards

##### Applications:

Designed for exterior and underwater applications, superior bond to concrete, cement renders, screeds.

##### Advantages:

- For fixing tiles & stone on demanding external & internal application
- Polymer modified super flexible adhesive with superior bond strength
- High performance in all types of weather
- Single component - Just add water

##### Suitable Substrates:

- Concrete • Concrete Masonry • Cement Mortar Beds • Cement Plaster • Ceramic Tile and Stone • Brick Masonry • Cement Backer Board\* • Cement Terrazzo • Gypsum Wallboard\*

\*Consult the backer board manufacturer's data sheet for the specific recommendations.

**Coverage:** Approx 55 - 60 sq ft per 20 kg bag with (6mmx6mm) square notch trowel for a bed of 3 mm

**Bed Thickness:** Can be used upto 12 mm

**Packaging:** 20 kg & 50 kg bags

**Colour:** Grey & White

**Compliance:** Meets the following standards

- ANSI: A 118.4 ET • EN 12004 / ISO 13007 : C2TE S1 • IS 15477:2019: TYPE 3 T S1 ADHESIVE • VOC: Practically Nil



### 325 HIGH FLEX

#### LATICRETE® 325 HIGH FLEX Ag "SILVER" FLOOR AND WALL TILE ADHESIVE

A multipurpose, high polymer modified powder offering vast utility including applications for floor & wall in interior & exterior areas. It is a cementitious thin-set powder to be mixed only with water to install various types of medium & large format tiles & stone on a variety of substrates.

##### Applications:

Designed specially for interiors, exterior floor & wall installations of all types of ceramic tiles, vitreous tiles, semi-vitreous tiles, glass mosaic tiles, precast terrazzo and natural stones over concrete and a variety of substrates.

##### Advantages:

- For fixing tiles & natural stone on interior & exterior floor & wall
- Polymer modified Bonds with various substrates
- Water & Shock resistant
- Single component - Just add water

##### Suitable Substrates:

- Concrete • Cement Mortar Beds • Ceramic Tile and Stone • Concrete Masonry • Cement Plaster • Brick Masonry • Cement Terrazzo • Gypsum Wall Board\*

\*Consult the backer board manufacturer's data sheet for the specific recommendations

**Coverage:** Approx. 55-60 sq.ft. per 20 kg bag with a 1/4" x 1/4" (6mm x 6mm) square notch trowel for a bed of 3mm.

**Bed Thickness:** Can be used upto 12 mm

**Packaging:** 5 kg, 20 kg and 50 kg bags

**Colour:** Grey and White

**Compliance:** Meets the following standards

- ANSI: A 118.4 ET • EN 12004 / ISO 13007: C2TE • IS 15477:2019:TYPE 3 T ADHESIVE • VOC: Practically Nil



## Polymer Based Adhesives



### 315 PLUS

#### LATICRETE® 315 PLUS PREMIUM FLOOR AND WALL TILE ADHESIVE

A high performance polymer based adhesive to be mixed with water or latex for installing medium & large format ceramic tiles, vitrified tiles, marble and stone on floors and walls. Combine with LATICRETE® 73 Crete Admix for improved performance.

**Applications:** Designed for interior floor & wall areas.

#### Advantages:

- For fixing ceramic, vitrified tiles & natural stone on interior floor & wall • Ideal for tile-on-tile & new floor tiling • High bond strength • Single component - Just add water

#### Suitable Substrates:

- Concrete • Cement Mortar Beds • Existing tiling on floor & wall • Ceramic Tiles and Stones • Concrete Masonry • Cement Plaster • Brick Masonry • Cement Terrazzo

**Coverage:** Approx. 55-60 sq. ft. per 20 kg bag with a ¼" x ¼" (6mmx6mm) square notch trowel for a bed of 3mm.

**Bed Thickness:** Can be used upto 12 mm

**Packaging:** 20 kg and 50 kg bags

**Colour:** Grey & White

**Compliance:** Meets the following standards

- ANSI: A118.1T • EN: 12004 / ISO 13007: C1T • IS 15477: 2019: TYPE 2 T ADHESIVE
- VOC: Practically Nil



### 307

#### LATICRETE® 307 FLOOR AND WALL TILE ADHESIVE

It is a smooth and creamy polymer based adhesive for installing small to medium format ceramic wall and floor tiles, vitrified tiles, small format natural stones in interior areas. (For improved performance and exterior use, fortify with LATICRETE® 73 Crete Admix).

**Applications:** Designed for internal floor & wall applications.

#### Advantages:

- For fixing ceramic tiles on interior floor & wall • Ideal for new tiling • Smooth & creamy • Single component - Just add water

#### Suitable Substrates:

- Cement Mortar Beds • Existing tiles/stones on floor & wall • Cement plaster • Brick Masonry • Cement Terrazzo

**Coverage:** Approx. 55-60 sq. ft. per 20 kg bag with a ¼" x ¼" (6mmx6mm) square notch trowel for a bed of 3mm.

**Bed Thickness:** Can be used upto 12 mm

**Packaging:** 20 kg and 50 kg bags

**Colour:** Grey & White

**Compliance:**

- ANSI: A 118.1T • EN 12004 / ISO 13007: C1T • IS 15477: 2019: TYPE 1 T ADHESIVE
- VOC: Practically Nil



## Polymer Based Adhesives

**305**

### LATAFIX 305 FLOOR AND WALL TILE ADHESIVE

A factory-made bagged cementitious polymer based powder, containing Portland cement and silica sand, it can be mixed with water for installing small and medium size ceramic floor tiles in interior areas using the thinset method of installation

**Applications:** Designed for internal floor applications.

**Advantages:**

- For fixing ceramic tiles on interior floor & wall • Ideal for new floor tiling • Economical & easy to use • Single component - Just add water

**Suitable Substrates:**

- Cement Mortar Beds • Cement Plaster • Brick Masonry • Cement Terrazzo

**Coverage:** Approx. 55-60 sq. ft. per 20 kg bag with a 1/4" x 1/4" (6mmx6mm) square notch trowel for a bed of 3mm.

**Bed Thickness:** Can be used upto 12 mm

**Packaging:** 20 kg and 50 kg bags

**Colour:** Grey

**Compliance:** Meets the following standards

- ANSI : Meets ANSI A 118.1 T • EN 12004 / ISO 13007: C1T • IS 15477: 2019: TYPE 1 T ADHESIVE • VOC: Practically Nil



## Epoxy Adhesives

**300**

### LATAPOXY® 300 EPOXY ADHESIVE

It is a high strength 100% solid epoxy adhesive, highly suitable for chemical resistant installation of quarry tile, brick and pavers on internal floors of food processing plants, commercial plants, commercial kitchens and beverage plants. Ideal for installing moisture sensitive marbles, it can be used on all metals, including copper.

**Applications:**

For heavy duty commercial chemical resistant installations in food processing areas, commercial kitchens, restaurants, etc. Also use LATAPOXY® 300 Epoxy Adhesive to install all types of ceramic tiles, marble and natural stone over post-tensioned and precast floor systems. Also recommended for rubber flooring and wood block floors. For the installation of green marble, white marble and agglomerate marbles that have a tendency to stain, darken, or warp when installed with water based installation materials.

**Advantages:**

- Ideal for fixing tiles, can be used over metal substrate • Superior bond strength • Fast setting

**Suitable Substrates:**

- Resin-backed Tiles • Mosaics • Stone • Agglomerates

**Coverage:** Varies in accordance with the size and type of the tile and stone installed.

**Bed Thickness:** Can be used upto 12 mm

**Packaging:** 5 kg

Factory proportioned unit consisting of three conveniently packed components - Hardener, Resin (Part A & Part B) and Filler Powder (Part C).

**Colour:** Grey & White

**Compliance:** Meets the following standards

- EN 12004 / ISO 13007: R2 T • IS 15477:2019 : TYPE 5 T • VOC: Very low





## Spot Bonding Adhesive

**310**

### LATAPOXY® 310 EPOXY CHEMICAL ANCHOR

LATAPOXY® 310 Epoxy Adhesive is a two component non-sag high strength epoxy chemical anchor ideally suited for spot fixing or attaching marble or stone slabs on walls and for installing marble tiles or heavy tiles in ceilings. LATAPOXY® 310 is ideal for external facades.

#### Applications:

- Spot bonding marble, granite, adhered masonry veneer and large format ceramic tile on walls and overheads, interior or exterior applications
- Ideal for fireplace surrounds, elevators and stair risers
- Adhesive for bedding and fastening marble, granite and other stone slabs on walls and wainscoting
- Adhesive for fabricating granite, marble and other stone

#### Advantages:

- Non-staining • Withstands shock and vibration • Durable permanent bond • Ideal for use on dry or damp surfaces • Can be used for fabricating marble and stone assemblies • No clamps / mechanical anchor needed

**Coverage:** 10 kg unit will yield approximately 100ft (10M<sup>2</sup>) with ¼" (6 mm) thick dab when covering 10% of the stone surface.

**Packaging:** 1 kg and 10 kg pails

**Colour:** Off white when mixed. May be coloured with dry pigments.

**Compliance:** Meets the following standards

- ANSI 118.3 • EN 12004 / ISO 13007: R2 T classification • IS 15477:2019: TYPE 5 T
- VOC: Very low



## Speciality Adhesives

**PUA 212™**

### MYK LATICRETE PUA 212™

It is a two component, modified Polyurethane Adhesive designed for the installation of ceramic tile, vitrified tile, metal tile, glass tile, agglomerates, glass mosaic tile and natural stone on any substrate. It is highly elastic, thixotropic and suitable to lay water sensitive tiles & stones on highly expandable, deformable, absorbent and non-absorbent substrates.

#### Applications:

Designed especially for interior and exterior floor and wall installations of all types of ceramic tile, vitreous, semi-vitreous tile, glass mosaic tiles, precast terrazzo, engineered stone, metal tiles and natural stones over concrete and on a variety of substrates including metal substrates and drywall boards.

#### Advantages:

- Highly flexible & superior bond strength • Suitable for all the substrates including metal
- Good for vertical applications • Ideal for agglomerates & moisture sensitive tiles / stones

#### Suitable Substrates:

- Concrete – VDF, Tremix and MIVON • Concrete masonry & brick masonry • Cement mortar beds & plaster • Metal floors and walls • Tile and stone • Wood & Plywood\* • Cement backer board\* & Gypsum board\* • Cement terrazzo • Engineered stones & marbles • Epoxy or PU resin based substrates • Rubber, PVC and Linoleum substrates

*\*Consult the backer board manufacturer's data sheet for the specific recommendations and load bearing capacity of specific board intended for use.*

**Coverage:** 15 to 17 sq.ft per pack of 8 kg with 1/4" x 1/4" (6mm x 6mm) square notch trowel for a bed of 3mm.

Coverage will vary depending on trowel notch size, type and size of tile and substrate smoothness and evenness.

**Packaging:** 8 kg Pail (Part A: 1.6 kg Part B: 6.4 kg) & 4 kg Pail (Part A: 800 g Part B: 3.2 kg)

Factory proportioned unit consisting of two conveniently packed components - Hardener, Resin (Part A and Part B)

**Colour:** Off White

**Compliance:** Meets the following standards

- EN: 12004 / ISO 13007 : R2T • IS 15477 : 2019 : TYPE 5 T • VOC: Very Low





## Speciality Adhesives



**The Perfect  
Bond for  
Dry Wall Boards**



### DWA 215™

#### MYK LATICRETE DWA 215™

It is a modified Polyurethane Adhesive designed for the installation of glass mosaic tile, ceramic tile, vitrified tile and natural stone on most drywall boards and clean dry cement based surfaces. MYK LATICRETE DWA 215™ is a factory made pail consisting of pre-blended single component adhesive which is ready to use.

#### Applications:

For commercial and residential installations of ceramic tile, vitrified tile and natural stone over most drywall boards and clean cement based surfaces. Used where installations must resist physical abuse, shock, and mild chemicals. (Interior & Exterior)

#### Advantages:

- Single Component / Ready to use
- High Bond Strength
- No on-site mixing
- Fast installation - Saves time
- Economical
- Can be used on various dry wall boards

#### Suitable Substrates:

- Concrete\*
- Cement mortar beds\*
- Plywood
- Gypsum wall board
- Calcium silicate board
- Bison panel board
- Concrete masonry\*
- Cement plaster\*
- AAC Block masonry\*
- Cement terrazzo\*
- Cement backer board\*\*
- Existing ceramic tile
- Other resilient tile and stone

\* All cement based surfaces should have been cured as per standard practices and shall be dry for tiling

\*\*Consult cement backer board manufacturer for specific installation recommendations and to verify acceptability for exterior use.

Note: Not for use on metal & plastic substrates and metal tiles.

**Coverage:** Approx. 58 sq.ft. per 20 kg unit with a 1/4" x 1/4" (6mm x 6mm) square notch trowel for a bed of 3mm.

**Packaging:** 10 kg & 20 kg pail

**Colour:** Off White

**Compliance:** Meets the following standards

- ANSI: A 118.4 & ANSI 136.1
- EN: 12004/ISO 13007: D2TE
- VOC: Very Low



### AAC Block

#### AAC BLOCK ADHESIVE

It is a factory prepared blend of carefully selected raw materials, portland cement and graded aggregates and polymers. Designed for use with water to produce high strength thixotropic mortar, for laying aerated light weight concrete, fly ash bricks, cement hollow blocks, cellular concrete blocks or smoothing over the block work surface in layers of upto 12mm thickness, that meet and exceed the requirements of National and International Standards.

**Applications:** For interior and exterior use for preparing thin bed block mortar for ALC and cellular concrete blocks.

**Advantages:** • Long working time • No curing required after block work is done • Improved adhesion between two blocks • Fast & economical

**Suitable Substrates:** • Concrete blocks • Cement mortar blocks/bricks • Concrete hollow blocks • Aerated light weight blocks • Cellular concrete blocks • Fly ash bricks

**Coverage:** Approximately 300 sq.ft. per 50 kg bag when used at 2mm bed thickness. Coverage is based on smoothness and evenness of the substrate, size of blocks used and the thickness of mortar used. A general guide line for coverage of mortar is given when used with 25% water added to powder.

**Note:** Coverage is based on the block size of 600mm X 200mm X 100mm

**Packaging:** 20 kg & 50 kg bags **Colour:** Grey

**Compliance:** Meets the following standards

- ANSI: A 118.1T
- EN: C1TE
- ASTM C 1660
- IS 15477: 2019: TYPE 1 T
- VOC: Practically Nil



## Stone Adhesives

**320**

### LATICRETE® 320 Thick bed Adhesive

Polymer modified thick bed adhesive for fixing small to large format stones on interior and exterior floor.

#### Applications:

Designed especially for interior and exterior floor installations of all types of natural stones over concrete and on a variety of substrates. Good underwater shear bond allows this product to be used for wet areas like swimming pools, sauna, water bodies and wash rooms. Can be used for tile on tile applications, ceramic and vitrified tiles also.

#### Advantages:

- Suitable for interior & exterior floor application
- High bond strength
- Supports heavy stones / Slabs
- Non sag & No lippage

#### Suitable Substrates:

- Concrete, Tremix concrete, VDF concrete
- Precast concrete
- Cement based screed
- Gypsum based screed
- Ceramic tile, Vitrified tile & Natural stone
- Cement terrazzo
- Cement backer board\*

\*Consult cement backer board manufacturer data sheet for the specific recommendations and load bearing capacity of specific board intended for use.

**Coverage:** Approx. 33-38 sq. ft. per 30 kg bag 1/2" x 1/2" (12mm x 12mm) square notch trowel.

**Bed Thickness:** Can be used upto 40 mm

**Packaging:** 30 kg bag

**Compliance:** Meet the following standards

- ANSI: A118.4
- IS 15477: 2019 : TYPE 2 ADHESIVE
- VOC: Very low

**340**

### LATICRETE® 340 Medium bed Adhesive

Highly polymer modified medium bed adhesive for fixing small to large format stones on interior and exterior wall.

#### Applications:

Designed especially for interior and exterior wall installations of all types of natural stones over concrete and on a variety of substrates. Good underwater shear bond allows this product to be used for wet areas like swimming pools, sauna, water bodies and wash rooms. Can be used for tile on tile applications, ceramic and vitrified tiles also.

#### Advantages:

- Suitable for stone installations on interior & exterior wall
- Complies to C2TES1 as per EN 12004/ISO 13007 and ANSI A 118.4 ET
- Non sag & No lippage

#### Suitable Substrates:

- Concrete & Concrete Masonry
- MIVON Concrete, Precast Concrete
- Cement Plaster
- Gypsum Wall Board
- Ceramic tile, Vitrified tile & Natural stone
- Cement terrazzo
- Cement backer board\*

\*Consult cement backer board manufacturer data sheet for the specific recommendations and load bearing capacity of specific board intended for use.

**Coverage:** Approx. 33-38 sq. ft. per 30 kg bag 1/2" x 1/2" (12mm x 12mm) square notch trowel.

**Bed Thickness:** Can be used upto 18 mm

**Packaging:** 30 kg bag

**Compliance:** Meet the following standards

- ANSI: A118.4 ET
- EN 12004 / ISO 13007 : C2TES1
- IS 15477: 2019 – TYPE 3 TS 1 ADHESIVE
- VOC: Very low



# GROUTS

Not using grouts when laying tiles can lead to problems ranging from chipped corners, water seepage, staining to even breeding of fungus and the tiles debonding or falling off.

Extensive studies and in-depth research by some of the most innovative minds in the business have seen the emergence of a new breed of grout that makes all others obsolete. The award-winning range is a perfect blend of aesthetics and performance and has become the new yardstick of quality.

## Advantages

- Stainfree
- Acid/chemical resistant
- Non-cracking/powdering
- Anti-fungal and anti-bacteria
- Easy application
- Available in a variety of shades





## Stainfree Grout



### STELLAR™

#### MYK LATICRETE STELLAR™ GROUT

It is a single component, high performance modified joint filling grout, which offers excellent colour uniformity, durability, stain protection, and beautiful grout joints in an easy-to-use, non-sag formula, with no hassle of mixing two packs or any other liquids like water or latex liquid.

#### Application

STELLAR™ Grout is best suited for internal & external tile joints grouting of residential / commercial installations where materials must resist physical abuse, shock & chemical attack. Excellent for external swimming pool & water bodies. It is NOT a waterproof material for joints or surfaces.

#### Advantages

- Single Component
- Suitable for joints of 1.5 mm to 12 mm
- Non-sag formula for floors and walls
- Designed for exterior use

**Coverage:** Varies with tile size and grout width

**Packaging:** 1/5th unit - 1 kg & 1 unit - 5 kg pails

**Colour:** Available in 5 colours



### SP-100™

#### SP-100™ Stainfree Grout for Floor N' Wall

SP-100™ Stainfree Grout for Floor N' Wall is a stainfree, colour-fast, chemical resistant, 100% solid epoxy grout suitable for ceramic tiles, vitrified tiles, marble and stone, especially in stain prone areas such as kitchens and washrooms (residential and commercial installations).

**Applications:** Kitchens, bathrooms, swimming pools, fountains, water bodies, hospitals, operation theatres, sterilization rooms, restaurants, cafeterias, light industrial applications and high traffic areas. It is NOT a waterproof material for joints or surfaces.

#### Advantages:

- 100% stainfree
- Strong and durable
- Chemical and temperature resistant
- Anti bacterial and anti fungal

**Coverage:** Varies with tile size and grout width

**Packaging:** 1/5th unit - 1 kg & 1 unit - 5 kg pails

Factory proportioned unit consisting of three conveniently packed components - Hardener, Resin (Part A and Part B) and Coloured Filler Powder (Part C).

**Colour:** Available in a range of more than 40 colours

**Compliance:** Meets the following standards

- ANSI: A 118.3
- EN 13888: RG2
- VOC: Very low





## Cementitious Grout



**600**

### LATICRETE® 600 SERIES UNSANDED GROUT

A carefully prepared blend of portland cement, graded aggregates, polymer fortifiers and colour-fast pigments, it is designed for joint width 1mm to 3mm, for porous & absorbent type tiles, non-vitreous clay tiles, and marble & glazed wall tiles. Suitable for internal and external applications.

**Applications:** Residential, commercial, external facades

**Advantages:** • For tile joints 1 - 3mm • Uniform colour • Hard and durable • Economical

**Mixing Ratio:** Use approx. 400 ml of water or LATICRETE® 1776 Grout Admix Plus for 1 kg of LATICRETE® 600 Series Unsanded Grout.

**Coverage:** Varies with tile size and grout width

**Packaging:** 500g, 1 kg and 10 kg bags

**Colour:** Available in a range of more than 36 colours

**Compliance:** Meets the following standards

- ANSI: A 118.6
- EN 13888: CG1
- VOC: Very low



**500**

### LATICRETE® 500 SERIES SANDED GROUT

LATICRETE® 500 Series Sanded Grout is made of polymer blended portland cement, graded aggregates, fortifiers and colour-fast pigments, it provides a tile joint that is strong, hard and durable. Designed for joint width of 3mm to 12mm for non-absorbent and vitreous tiles, it is suitable for interior and exterior use.

**Applications:** Residential, commercial, external facades

**Advantages:** • For tile joints 3-12mm • Uniform colour • Hard and durable • Economical

**Mixing Ratio:** Use approx. 2 ltr of LATICRETE® 1776 Grout Admix Plus for 10 kg of 500 Series Sanded Grout.

**Coverage:** Varies with tile size and grout width

**Packaging:** 10 kg bag

**Colour:** Available in a range of more than 36 colours

**Compliance:** Meets the following standards

- ANSI: A 118.6
- EN 13888: CG1
- VOC: Very low



## Grout Admix



**1776**

### LATICRETE® 1776 GROUT ADMIX PLUS

LATICRETE® 1776 Grout Admix Plus is specially designed Latex Admix to be used with Sanded & Unsanded Grout.

**Applications:** It improves the performance of portland cement grouts for all types of ceramic tile, brick, marble, natural stone and agglomerate stone installations.

**Advantages:** • Colour-fastness • Flexibility • Compressive strength • Shock and chemical resistance • Reduces water absorption • Easy to clean

**Coverage:** Varies by application.

**Packaging:** 200 ml, 400 ml, 5 ltr and 20 ltr. pails

**Compliance:** • VOC: Very low



## Speciality Grout



### Dazzle™

#### LATAPOXY® Dazzle™ Grout for Floor N' Wall

LATAPOXY® Dazzle™ Grout for Floor N' Wall is an epoxy grout specifically designed to enhance aesthetics and performance. It is suitable for use with ceramic tiles, vitrified tiles, glass mosaic tiles, designer tiles and natural stone.

**Applications:** • Restaurants • Hotels • Kitchens • Bathrooms • Lobbies • Swimming Pools • Showrooms

**Advantages:** • Good aesthetic appeal • Stainfree • Strong & durable • Chemical & temperature resistant

**Coverage:** Varies with tile size and grout width

**Packaging:** Net Weight: 1/4 unit (1.25 kg); 1 unit (5 kg) pails

Factory proportioned kit consisting of three conveniently packed components - Hardener, Resin (Part A and Part B) and Dazzle Coloured Filler Powder (Part C).

**Colour:** Available in 10 colours and 3 finishes - Gold, Silver and Copper

**Compliance:** Meets the following standards

- ANSI: A 118.3
- EN 13888: RG2
- VOC: Very low



### 2000

#### LATAPOXY® 2000 Industrial Epoxy Grout

Three part, 100% solid epoxy grout specifically formulated for maximum chemical and high temperature resistance. It is recommended for extreme industrial and commercial applications such as dairies, food processing units, commercial kitchens, breweries, beverage plants, pharmaceuticals, and meat packaging plants.

**Applications:** Industrial food processing plants, beverage plants, battery plants and environments requiring high temperature and chemical resistance.

**Advantages:**

- Heavy duty industrial grout • Superior chemical & heat resistance • Water cleanable & fast curing • Highly resistant to bacteria attack

**Coverage:** Varies with tile size and grout width

**Packaging:** #2 unit (10 kg) pail

Factory proportioned unit consisting of three conveniently packed components - Hardener, Resin (Part A and Part B) and Coloured Filler Powder (Part C)

**Colour:** Black and Grey

**Compliance:** Meets the following standards

- ANSI: A 118.3
- EN 13888: RG2
- VOC: Very low



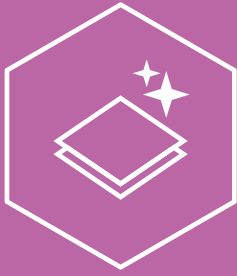

# STONE CARE PRODUCTS

## Spa treatment for stone and tile floors

Just like how a refreshing spa experience rejuvenates, revives and helps us look our best, stone and tile floors too, thrive when lavished with such care.

MYK LATICRETE, the leader in the stone and tile installation industry, presents a world class range of innovative products – Sealers, Enhancers, Cleaners - that augment the appearance of interiors and exteriors while adding years to the life of stone and tile.

### Sealers

Natural stone is highly porous in nature, which allows water and oil to seep in, leading to stains and discolouration. It is also prone to deposits of soil, rust, stains, moss and efflorescence.

To overcome this problem, MYK LATICRETE Sealers are 'impregnated' into the stone to form an invisible barrier that is resistant to moisture and stains. Since this is not a surface coating, the natural look of the stone is not altered.

### Enhancers

To augment the colour and gloss of all natural stone surfaces, MYK LATICRETE Enhancers are unique products that add to the aesthetics of internal or external space even as they leave behind a stain-free, water & weather-resistant surface.

### Cleaners

To help maintain floors and walls in pristine condition, MYK LATICRETE Cleaners come in handy. Fast acting and easy to use, these products ensure that stones and tiles are dirt and stain-free and at their sparkling best.





## Sealers



### MaxiSeal plus

MaxiSeal plus is a nano technology based impregnating sealer designed for the protection of all highly porous tile/stone and grout surfaces. This product imparts oleo phobic properties, highly resistant to oil, water, alkalis, acid staining and freeze-thaw damages. It penetrates into the surface and forms an invisible barrier by allowing vapour to escape. It keeps the natural colour of tile & stone intact. All surfaces treated with MaxiSeal plus are harder and less slippery. It is ideal for interior as well as exterior applications and recommended for granite, marble, sand stone, porous slate, brick and sanded grout.

Surface should be thoroughly dry & moisture free and cleaned preferably by clean cloth, brush or vacuum cleaner before applying the sealer.

#### Applications:

- For interior & exterior applications on tile and stone surfaces

#### Advantages:

- Nano-impregnating technology • High resistance to oil stains • Weather resistant
- Superior coverage • Economical • Easy to use • U.V. resistant • Low VOC after application
- Resistance to stains, water & oil repellent

**Coverage:** 25 - 400 sq.ft. per litre depending on porosity of the substrate.

**Packaging:** 1, 5 ltrs. cans & 20 ltrs. pails

**Field Test:** It is highly recommended to perform field test to understand the absorption nature of the substrate. This will help maximize the performance and efficiency of MaxiSeal plus.



### MaxiSeal aqua

MaxiSeal aqua is nano technology based impregnating sealer with water as a carrier designed for the protection of all highly porous tile/stone and grout surfaces. This product imparts oleo phobic properties, highly resistant to oil, water, alkalis and acid staining damages. It penetrates into the surface and forms an invisible barrier by allowing vapour to escape.

It keeps the natural colour of tile & stone intact. All surfaces treated with MaxiSeal aqua are harder and less slippery. It is ideal for interior as well as exterior application and recommended for grout, ceramic tiles, porcelain tiles, granite, marble, lime stone and brick.

Surface should be thoroughly dry & moisture free and cleaned preferably by clean cloth, brush or vacuum cleaner before applying the sealer.

**Applications:** • For interior & exterior applications on tile and stone surfaces

#### Advantages:

- Nano-impregnating technology • High resistance to oil stains
- Weather resistant • Superior coverage • Economical • Easy to use • U.V. resistant
- Low VOC after application • Water repellent

**Coverage:** 25 - 400 sq.ft. per litre depending on porosity of the substrate.

**Packaging:** 1, 5 ltrs. cans & 20 ltrs. pails

#### Field Test:

It is highly recommended to perform field test to understand the absorption nature of the substrate. This will help maximize the performance and efficiency of MaxiSeal aqua.





## Sealers

After sealer application



Absorption of stains before application of sealer



### MaxiSeal

MaxiSeal is a nano technology based impregnating sealer designed for the protection of all medium to dense porous tile/stone and grout surfaces. This product is formulated for resistance against water, alkalis, acid staining and freeze-thaw damages.

It penetrates into the surface and forms an invisible barrier by allowing vapour to escape. It keeps the natural colour of tile & stone intact. All surfaces treated with MaxiSeal are harder and less slippery. It is ideal for interior as well as exterior applications and recommended for grout, brick & masonry surfaces, granite, marble, ceramic and porcelain tiles.

Surface should be thoroughly dry & moisture free and cleaned preferably by clean cloth, brush or vacuum cleaner before applying the sealer.

#### Applications:

- For interior & exterior applications on tile and stone surfaces

#### Advantages:

- Nano-impregnating technology • Weather resistant • Superior coverage • Economical
- Easy to use • U.V. resistant • Low VOC after 72 hrs of application • Resistance to stains water repellent

**Coverage:** 25 - 500 sq.ft. per litre depending on porosity of the substrate.

**Packaging:** 1, 5 ltrs. cans & 20 ltrs. pails

#### Field Test:

It is highly recommended to perform field test to understand the absorption nature of the substrate. This will help maximize the performance and efficiency of MaxiSeal.



### LATICRETE® 190 Sealer

LATICRETE® 190 Sealer is a nano technology based penetrating sealer which forms an invisible water repellent coating. Applied on natural stone, marble, brick, limestone and mortar joints, it will seal the surface to reduce staining and water absorption. It will not change the colour of the stone and ceramic tile.

#### Uses:

- Interior and exterior sealer to protect installations
- Seals mortar and plaster
- Reduces the effect of efflorescence
- Can be used as a grout release by treating ceramic tile before the application of grout
- Repels water and rain

#### Applications:

Residential & commercial, ideal for soft and natural stone, marble and porous tiles.

#### Advantages:

- Weather resistance - protects stone, brick and tile
- Easy to apply - no special tools required
- Water-based, non-flammable
- VOC: Very low

**Coverage:** Approximately 75 sq. ft. per litre.

**Packaging:** 1, 5 ltrs. cans & 20 ltrs. pails.



## Colour • Gloss Enhancers



### Preserva plus

Preserva plus is a single component solution for enhancing and sealing the natural colour of flamed, tumbled and textured stone surfaces. Preserva plus functions on the surface of the substrates. It penetrates into the surface and forms an invisible barrier by allowing vapour to escape. It enriches and gives a wet look to the natural color of the stone and tile.

It protects tile/stone surfaces against oil based stains. All surfaces treated with Preserva plus are harder and less slippery. It is ideal for interior as well as exterior application and recommended for Flamed Granite, Flamed Limestone, Tumbled Marble, Textured Natural Stone.

Surface should be thoroughly dry & moisture free and cleaned preferably by clean cloth, brush or vacuum cleaner before applying the product.

**Applications:** • For interior & exterior applications on textured natural stone surfaces.

**Advantages:**

- Nano-impregnating technology • Weather resistant • Superior coverage • Economical
- Easy to use • U.V. resistant • Low VOC after application • Water repellent • Stain resistant • Oil repellent

**Coverage:** 25 - 400 sq.ft. per litre depending on porosity of the substrate.

**Packaging:** 1, 5 ltrs. cans & 20 ltrs. pails

**Field Test:**

It is highly recommended to perform field test to understand the absorption nature of the substrate. This will help maximize the performance and efficiency of Preserva plus.



### Preserva

Preserva enhances the natural colour of flamed, tumbled and textured stone surfaces. When combined with our range of Sealers, it preserves and enhances the original beauty of the unsealed natural stone. Preserva functions on surface of the substrates. It penetrates into the surface and forms an invisible barrier by allowing vapour to escape. It enriches and gives a wet look to the natural colour of the stone and tile. All surfaces treated with Preserva are harder and less slippery. It is ideal for interior as well as exterior applications and recommended for Flamed Granite, Flamed Limestone, Tumbled Marble and Textured Natural Stone.

Surface should be thoroughly dry & moisture free and cleaned preferably by clean cloth, brush or vacuum cleaner before applying the product.

**Applications:**

- For interior & exterior applications on textured natural stone surfaces.

**Advantages:**

- Nano-impregnating technology • Weather resistant • Superior coverage • Economical
- Easy to use • U.V. resistant • Low VOC after application • Wet look

**Coverage:** 25 - 400 sq.ft. per litre depending on porosity of the substrate.

**Packaging:** 1, 5 ltrs. cans & 20 ltrs. pails

**Field Test:**

It is highly recommended to perform field test to understand the absorption nature of the substrate. This will help maximize the performance and efficiency of Preserva.

## Cleaners



### ClenzaEG

Clenza EG is a non-acid cleaner to remove epoxy grout haze from tile, concrete and stone surfaces. The unique non-acidic formula makes it safe to be used on marble and other calcium based stones. Clenza EG does not leave behind residue or any harmful deposits. In addition to epoxy, Clenza EG will also remove acrylics, gums, varnishes, lacquers etc. Clenza EG is fast acting and easy to use.

#### Applications:

- Ceramic tiles • Vitrified tiles • Natural stone • Concrete

#### Advantages:

- Fast acting
- Non-acidic
- Non-corrosive
- Easy to use

**Coverage:** 15 - 50 sq.ft. per litre depending on porosity of the substrate.

**Packaging:** 1, 5 ltrs. cans & 20 ltrs. pails



### ClenzaGA

Clenza GA is an acidic cleaner which can be used to remove grout and adhesive haze, hard water deposit and other hard stains from tile and stone surfaces. Clenza GA is water soluble and can be used at desired concentration levels for stain removal. Clenza GA can be used in interior as well as exterior applications.

#### Applications:

- Ceramic tiles • Vitrified tiles • Concrete\* • Masonry • Glass tile

\*Acidic cleaners may leave a mark on the surface and also may damage.

#### Advantages:

- Fast acting
- Non-acidic
- Non-corrosive
- Easy to use
- Economical

**Coverage:** 15 - 50 sq.ft. per litre depending on porosity of the substrate, degree of efflorescence, stains and dilution

**Packaging:** 1, 5 ltrs. cans & 20 ltrs. pails

## Cleaners



### ClenzaEF

Clenza EF is an acidic cleaner which can be used to remove efflorescence from tile and stone surfaces. Clenza EF is water soluble and can be used in both interior and exterior applications.

#### Applications:

- Ceramic tiles • Vitrified tiles • Natural stone\* • Concrete\* • Quarry tile

\*Acidic cleaners may leave a mark on the surface and also may damage.

#### Advantages:

- Fast acting
- Easy to use
- Low odour

**Coverage:** 15 - 50 sq.ft. per litre depending on porosity of the substrate, degree of efflorescence, stains and dilution

**Packaging:** 1, 5 ltrs. cans & 20 ltrs. pails



### ClenzaMC

Clenza MC is a non-toxic cleaner which can be used for daily maintenance of marble flooring. The neutral pH cleaner is most suitable for cleaning marbles and other calcium based stones. Clenza MC is also recommended for regular maintenance of sealed stone surfaces.

#### Applications:

All types of marble surfaces

#### Advantages:

- Interior & exterior use
- Economical
- Fast acting
- Easy to use

**Coverage:** 50 - 150 sq.ft. per litre depending on porosity of the substrate.

**Packaging:** 1, 5 ltrs. cans & 20 ltrs. pails



## Tile Cleaner



### CLENZA TC

CLENZA TC is a fast acting acid based cleaner for regular cleaning of dirt and stains on tile surfaces. CLENZA TC is designed for daily maintenance of tiles. It is ideal for interior and exterior use.

#### Applications:

- Unglazed Ceramic Tile • Glazed Ceramic Tile • Vitrified Tile
- Porcelain Tile • Glass Tile

#### Advantages:

- Cleans dirt and removes stains
- Easy to use
- Fast acting

**Coverage:** Depends on porosity of the substrate.

**Packaging:** 1 ltr can



## Cement Additives



### **SUPER SET®**

MYK LATICRETE SUPER SET® is a macromolecule based polymer concentrate liquid to be mixed with water and used with cement for installing ceramic tile, vitrified tile and natural stone using the traditional cement slurry method of installation. It is very economical and works as a great enhancer for cement slurry bonding with tiles and stones removing the need for water curing.

#### **Application:**

Can be used for interior and exterior applications on floors over concrete and mortar beds.

#### **Advantages:**

- **Purpose** - Traditional cement slurry additive
- **Easy to use** – Paste form easily dispersible in water
- **Polymer based** – High adhesion, more open time and adjustability
- **Better performance** – Compared to traditional system of only cement slurry tiling
- **Special Polymers** – Self curing of cement slurry
- **Economical** – Highly economical to use with many benefits
- Can be used with Grey Cement or White Cement

#### **Suitable Substrates:**

Traditional Wet on Wet system - Cement Mortar Beds

**Mixing Ratio:** Only 300ml to be mixed in water and used with 50 kg bag of cement

**Packaging:** 300ml

**Colour:** White liquid



### **SUPER SET® IWP**

It is a Single Component, specially designed with Polymers & Additives to minimize shrinkage and reduce water permeability of cement concrete, plaster and mortar.

#### **Applications:**

- Roof concrete • Screeds • Water tanks & Water retaining structures • Cement based Plasters • Bathrooms and balconies • Sumps and drains.

#### **Advantages:**

- Reduces the water Permeability into cement concrete
- Reduce the water demand of cement mixes
- Increase the waterproofing properties

**Dosage:** 200ml per 50 kg bag of Cement

**Packaging:** 200ml, 1L, 5L, 20L.

**Compliance:** Meets the following standards

- IS 2645:2003



Disclaimer: The images shown are for illustration purposes only and may not be an exact representation. Super set IWP is integral waterproofing compound only. For complete waterproofing solutions please contact MYK LATICRETE representative.



# LATAFINISH<sup>®</sup> WALL PUTTY

LATAFINISH<sup>®</sup> Wall Putty from MYK LATICRETE not only strengthens walls but also protects expensive paint from dampness and moisture. Vastly superior to any other wall putty available in the market today, it serves as the best sub-surface for all types of interior and exterior paint applications. Its greater adhesive properties enable perfect bonding with the base and paint, providing a bright, even finished surface that effectively eliminates the need for primer. Benefitting you with considerable savings of time and money.





## LATAFINISH® Wall Putty



LATAFINISH® Wall Putty complies with International Standards and is tested as per World Renowned C.B.R.I., Roorkee.

### LATAFINISH® Wall Putty (FINE FINISH)

LATAFINISH® Wall Putty is a unique formulation of white cement and high performance chemicals and polymers which can be applied on damp as well as dry surfaces.

#### Advantages:

- White cement based Wall Putty
- White, smooth & glossy finish
- Does not allow paint to flake
- Protects paint from moisture
- Curing is not required
- Ideal for interior & exterior walls

#### Coverage:

LATAFINISH® Wall Putty covers approx. 16 to 20 sq. ft. per kg for 2 coats, maintaining a maximum thickness of 1.5 mm on smooth plaster surface.

#### Available pack sizes:

40 kg, 20 kg, 5 kg & 1 kg bags

#### Compliance:

- VOC: Very low



### LATAFINISH® Wall Putty (COARSE FINISH)

LATAFINISH® Wall Putty - Coarse Finish is made of white cement, polymers, carefully graded fine aggregates & biocides. It has to be mixed with water at the time of application. LATAFINISH® - Coarse Finish is used to make uneven surfaces level and smooth and is designed for both interior and exterior surfaces.

#### Advantages:

- Easy to apply
- Good compressive strength
- Water resistant
- Good tensile strength
- Anti-fungal
- Covers undulations of plastered surfaces

#### Coverage:

LATAFINISH® Wall Putty covers approx. 4 to 10 sq.ft. per kg for 3mm thickness. The coverage depends upon the quality of base surface and surface evenness.

#### Packaging:

40 kg & 20 kg bags

#### Compliance:

- VOC: Very low

## Product Recommendation Chart

### Application-Wise

Area of Application	Description	Product Recommendation		
Surface Preparation - Internal and External Floor	Screed	(i) L 226 + L 3642 (ii) LATASCREED® 100 (iii) Site mixed cement and sand + L 3642		
Surface Preparation - Internal and External Wall	Plaster	(i) L 226 + L 3642 (ii) Site mixed cement and sand + L 3642		
INTERNAL FLOOR				
Substrate	Type of Finish	Product System Recommendation		
Internal cement floor	Ceramic Tiles	(i) L 315 PLUS	(ii) L 307	(iii) L 305
	Vitrified Tiles	(i) L 325 HIGH FLEX	(ii) L 315 PLUS	(iii) L 307
	Glass Mosaic Tiles -Paper Fased	(i) L 254	(ii) L 335 SUPER FLEX	(iii) L 325 HIGH FLEX
	Metal Tiles/ Fiber Mesh backed Tile & Stone	(i) L 300	(ii) PUA 212	
	Low Porous Stones	(i) L 254	(ii) L 335 SUPER FLEX	(iii) Xtrabond FSA 336
Internal - wood/ plywood floor**	Ceramic Tiles & Vitrified Tiles	(i) L 300	(ii) PUA 212	(iii) L DWA 215
	All Natural Stones	(i) L 300	(ii) PUA 212	(iii) L DWA 215
	All Engineered Stones	(i) L 300	(ii) PUA 212	
	Glass Mosaic Tiles - All Types	(i) L 300	(ii) PUA 212	(iii) L DWA 215
	Metal Tiles	(i) L 300	(ii) PUA 212	
Internal - metal floor	Any Tile/ Stone	(i) L 300	(ii) PUA 212	
EXTERNAL FLOOR				
External - concrete/ cement floor	Ceramic Tiles/ Vitrified Tiles/Glass Mosaic Tiles/ Natural Stones	(i) L 254	(ii) L 335 SUPER FLEX	(iii) Xtrabond FSA 336
	Metal Tiles / Fiber Mesh backed Tile & Stone	(i) L 300	(ii) PUA 212	
	Engineered Stones	(i) L300	(ii) PUA 212	
INTERNAL WALL				
Internal - concrete/ plaster wall	Ceramic Tiles	(i) L 325 HIGH FLEX	(ii) L 315 PLUS	(iii) L 307
	Vitrified Tiles	(i) L 335 SUPER FLEX	(ii) L 325 HIGH FLEX	(iii) L 315 PLUS
	Glass Mosaic Tiles - Paper Faced	(i) L 254	(ii) L 335 SUPER FLEX	(iii) L 325 HIGH FLEX
	Small Format Stones	(i) L 335 SUPER FLEX	(ii) L 325 HIGH FLEX	(iii) L 315 PLUS
	Large Format Stones	(i) L111+ L 4237	(ii) L 111 + L 73	(iii) L 254 / L 335 SUPER FLEX / L 340
	Metal Tiles / Fiber Mesh backed Tile & Stone	(i) L 300	(ii) PUA 212	
Internal - wood/ plywood wall*	Ceramic / Vitrified Tiles /Glass Mosaic Tiles	(i) L 300	(ii) PUA 212	(iii) L DWA 215
	Metal Tiles	(i) L 300	(ii) PUA 212	
	All Natural Stones	(i) L 300	(ii) PUA 212	(iii) L DWA 215
	Engineered Stones	(i) L 300	(ii) PUA 212	
Internal - gypsum wall board wall / calcium silicate board wall / cement backer board wall	Ceramic / Vitrified Tiles / Glass Mosaic Tiles - Paper Faced	(i) L DWA 215	(ii) L 254	(iii) L 335 SUPER FLEX
All Types of Dry Wall Boards	Fiber Mesh backed Tile & Stone	(i) L 300	(ii) PUA 212	
Internal wall - Concrete (more than M25 grade) & metal wall : Spot bonding method	Any Tile/ Stone	(i) L 310		
EXTERNAL WALL				
External - concrete/ plaster wall	Ceramic / Vitrified tiles / Glass Mosaic Tiles - Paper Faced	(i) L 254	(ii) L 335 SUPER FLEX	(iii) L 325 HIGH FLEX
	Natural Stones	(i) L 111+ L 4237	(ii) L 111+ L 73	(iii) L 254 / L 335 SUPER FLEX / L 340
	Medium Format Stones	(i) L 254	(ii) L 335 SUPER FLEX	(iii) L 325 HIGH FLEX
External wall - Concrete (more than M25 grade) & metal wall : Spot bonding method	Any Tile/ Stone	(i) L 310		

## Product Recommendation Chart

### Application Wise

GROUTING				
Area of Application	Description	Product Recommendation		
INTERNAL FLOOR & WALL				
Internal floor/ wall - Residential	Living areas	(i) SP-100™ /Dazzle™	(ii) STELLAR™	(iii) L 600 + L1776 / L 500 + L 1776
	Bathrooms, kitchen, swimming pool & water bodies	(i) SP-100™ /Dazzle™	(ii) STELLAR™	
Internal floor/ wall - Commercial	Office rooms, meeting rooms, toilets, cafeterias etc.	(I) SP-100™	(ii) STELLAR™	(iii) L 600 + L1776 / L 500 + L 1776
		(I) SP-100™	(ii) STELLAR™	(iii) L 600 + L1776 / L 500 + L 1776

EXTERNAL FLOOR & WALL			
External floor/ wall - Residential	(i) STELLAR™	(ii) L 600 + L 1776 / L 500 + L 1776	

WATERPROOFING			
Residential/ Commercial	Bathrooms / Washrooms	Hydro Ban®	L 9237 + Reinforcing Fabric
	Swimming Pools/ Plunge Pools / Suspended Pools/ terrace Gardens /Sauna	Hydro Ban®	L 9237 + Reinforcing Fabric
	External walls	Hydro Ban®	L 9237 + Reinforcing Fabric

WALL PUTTY		
Interior/ exterior	Walls & Ceilings with >3mm undulations	LATAFINISH® Wall Putty (Coarse Finish) + LATAFINISH® Wall Putty (Fine Finish)
	Walls & Ceilings with good Plumb & Level	LATAFINISH® Wall Putty (Fine Finish)

STONE CARE PRODUCTS					
Side & Back Coat			Top Surface Coat		
Interior/ exterior - floor: Sealers	Natural stone	L 190 Natural stone installed using an adhesive only. Not recommended for natural stones installed with traditional cement slurry system.	MaxiSeal Aqua	MaxiSeal Plus	MaxiSeal
Interior/ exterior - floor: Enhancers	Natural Stone	NA	Preserva Plus	Preserva	
Interior/ exterior - wall: Sealers	Natural Stone	NA	MaxiSeal Aqua	MaxiSeal Plus	MaxiSeal

Note: Adhesives and Grouts are not to be used as replacement of waterproofing membranes. In case of waterproofing requirements, use recommended waterproof membrane.

Contact MYK LATICRETE technical services for information

\* Consult wood/plywood manufacturer for specific installation recommendations





**MYK LATICRETE INDIA PVT. LTD.,**

**Registered Office:** 8-2-703/A, 4th Floor, Leela Gopal Towers, Road No.12, Banjara Hills, Hyderabad - 500 034.

Ph. No.: + 91 40 6817 3100 | Email: [contact@myklaticrete.com](mailto:contact@myklaticrete.com) | [www.myklaticrete.com](http://www.myklaticrete.com)

CIN: U99999TG1999PTC031624

**Regional Offices:** Ahmedabad: 09377532991 Bengaluru: 080-26757961 Bhubaneswar: 09078085131 Chennai: 044-43518843

Coimbatore: 0422-2644485 Ghaziabad: 09350621097 Indore: 09301532851 Jaipur: 0141-2210079 Kochi: 0484-2577113

Kolkata: 09681075242 Lucknow: 0522-4024125 Ludhiana: 0161-2503686 Mumbai: 022-26397453 Nagpur: 09325250899

New Delhi: 011-43020146 Panchkula: 0172-5033818 Pune: 020-24213394 Vijayawada: 09396707764 Visakhapatnam: 07032640887.

Follow us on



/myklaticreteindia



/c/myklaticreteindia



/company/myk-laticrete-india-pvt-ltd



Available on:



Scan for  
E-Catalogue